

Getting to know your logger

LED Status

	Green & red single flash (together) The data logger is in push-to-start mode	Push button to start logging
	Green single flash The data logger is currently logging No alarm has been triggered	No action required
	Red single flash The data logger is currently logging The low alarm has been triggered!	Check your logger's status using your Android™ device
	Red double flash The data logger is currently logging The high alarm has been triggered!	Check your logger's status using your Android™ device
	No LEDs flash The data logger is stopped or is in delayed start mode	Check your logger's status using your Android™ device

LCD Screen

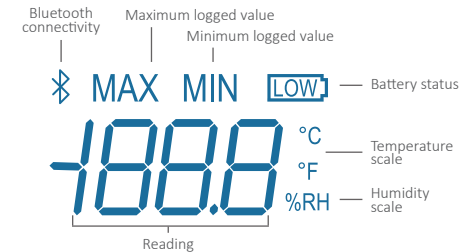

- Off** Not connected
- Flashing** Connection available
- Solid** Connected
- Off** Battery OK/charged
- Flashing** Battery charging
- Solid** Battery low (connect charger)
- Reset maximum and minimum
- Delayed start
- Push to start

Important safety information

WARNING: Failure to follow these safety instructions could result in fire, electrical shock, other injury or damage.



Repairing or modifying

Never attempt to repair or modify Lascar products. Dismantling them, other than for the purpose of changing replaceable batteries, may cause damage that is not covered under the warranty. Servicing should only be provided by an authorized supplier.



Disposal and recycling information

You must dispose of Lascar products in accordance with relevant laws and regulations. They contain electronic components and lithium batteries and therefore must be disposed of separately from household waste.

Need help with your data logger?

Contact your nearest Lascar Electronics office:



UK Module House
Whiteparish, Salisbury,
Wiltshire SP5 2SJ
UNITED KINGDOM
T +44 (0) 1794 884567
E sales@lascar.co.uk

USA 4258 West 12th Street
Erie, PA 16505
UNITED STATES
T +1 (814) 835-0621
E us-sales@lascarelectronics.com

HK 8th Floor, China Aerospace Centre
143 Hoi Bun Road
Kwun Tong, Kowloon
HONG KONG
T +852 2389 6502
E sales@lascar.com.hk

For more information visit www.easylogbt.com



EASYLOG BLUETOOTH
QUICK START GUIDE

1 Charge your data logger

Your data logger will arrive partially charged. For optimum performance, charge it for 24 hours before use until no battery symbol is displayed. Please use the USB cable provided.

Battery states

The symbols below show the various battery states:

Battery OK/charged



No symbol displayed

Battery low



Solid

Battery charging



Flashing

2 Install Android™ app available on Google Play™

Before the data logger can be set up, you must install the EasyLog BT app available on Google Play™. The sensor will display a reading, but it will not record until the app is installed and setup is complete.



3 Set-up the data logger

Open the EasyLog BT app on your Android™ device and follow the on-screen instructions for connecting your logger.

A Bluetooth connection is established after pressing the button on the logger, then selecting that logger from the scanned list in the Android™ app. You will be prompted with a Bluetooth pairing request. Enter the default logger password that is listed on-screen or on the back of the logger.

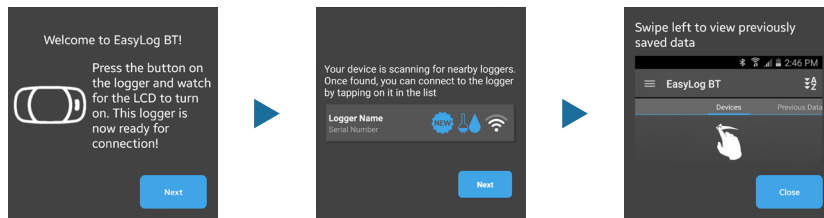

Connection status

Wireless connectivity is enabled for two minutes after pressing the button on the logger. The Bluetooth symbol will flash to show connection is possible. While connected, the Bluetooth logo will be on solidly. During the setup process there are options to keep the display and/or Bluetooth module on at all times, but this will severely limit the battery life.

Android™ app features

Within the app you can set the sample rate, temperature scale, temperature and humidity alarms, Bluetooth power-save settings, LCD settings and variable start times. Downloaded data will be saved to your phone's memory card and can be viewed any time. This data can then be sent via email or your preferred cloud service, to another device or PC for further analysis.

4 Your logger is now ready

For a full product data sheet for your logger, or for more information on the rest of the EasyLog range visit www.lascarelectronics.com

